

For great comfort and style

A superb addition to any home



**SECURITY
FIREPLACE**

SE36

HEAT-CIRCULATING
WOOD-BURNING
FIREPLACE

***Now's the time to
warm up your life
with a beautiful
fireplace***

It's a dream for many of us. A home with a beautiful fireplace where you can enjoy some of life's most precious moments in front of a cozy fire.

Now that dream can come true with an SE36 heat-circulating wood-burning fireplace. This stylish, superbly well designed unit will add value and more than a touch of warmth and beauty to your home.

In addition to a wide choice of easy-to-install brass trims and decorative contours, the SE36 comes with many outstanding features, including an ultra realistic refractory interior, a deep firebox, and a large opening for an optimal view of the flames.

Best of all, the SE36 is engineered for the easiest possible installation, making it the ideal choice for new construction and renovation projects alike. 

SE36

HEAT-CIRCULATING WOOD-BURNING FIREPLACE



The SE36 comes with a rigid firescreen and bi-fold doors with tempered glass.

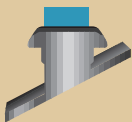

SECURITY CHIMNEYS INTERNATIONAL

Security Chimneys International Ltd.
2125 Monterey
Laval (Quebec)
Canada H7L 3T6
Tel.: (450) 973-9999
Fax.: (450) 973-2222
Visit us at: www.SecurityChimneys.com



ASE36
08-2007
REV: 1
Printed in Canada



FEATURES AND CHARACTERISTICS

SE36 heat-circulating wood-burning fireplace offers a host of standard features, including:

STANDARD FEATURES

- Zero clearance on back, sides and top offers greater decorating flexibility
- A trapezoidal shape requiring 35% less floor space for corner installations
- Ultra realistic refractory interior with rounded edges
- 16" deep firebox
- A broad view of the fire (20 1/2" high by 36" wide)
- Heavy duty steel wood grate
- Pre-installed decorative rigid firescreen for greater safety
- Pre-installed bi-fold doors
- Adapter for outside air kit included
- Knock-out on both sides for outside air kit installation
- Easy access chimney damper
- Convenient retainer ledges for easy stud and drywall installation
- Gas knock-out on both sides for gas log installation

DECORATIVE OPTIONS

- Wide choice of easy-to-install brass trims and decorative contours

OPTIONS

- Outside air kit (4" I.D. x 10' long insulated flex)
- Heat activated on/off pre-wired fan kit
- Forced air heating kit

Firebox fully covered in refractory brick for a natural look

Attractive louvers guaranteed to please



Pre-installed bi-fold doors for that elegant look

Heavy duty steel wood grate

Rigid firescreen for greater safety

CHIMNEY SYSTEM

- ASHT+ 7" I.D. insulated chimney
- S-2100+ 7" I.D. insulated chimney
- Air cooled 7" pipe

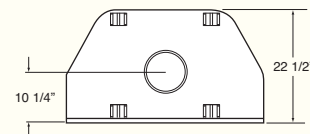

IMPORTANT NOTES:

Diagrams, illustrations and photographs are not to scale - consult installation instructions. Product designs, materials, dimensions, specifications, colors and prices are subject to change or discontinuance without notice.

D I S T R I B U T E D B Y :